

Moodleguide



Last revised 24 Feb 2009

Moodle version 1.9

Logging on

This Moodleguide looks at:

- how to log on
- storing a link to your Moodle site
- changing passwords

How to log on

Your Moodle site has a normal web address. Make a note of it.



Once you get to the website, enter your username and password.

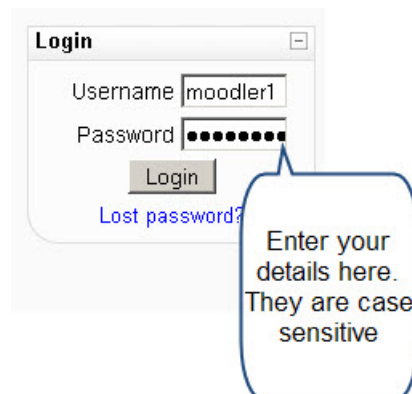

If you have forgotten your username and password, click login and you will see the helpdesk details. Here they are

Help desk support

Can't log in? [email helpdesk@olp.org.uk](mailto:helpdesk@olp.org.uk) or call

When emailing, please tell us your name.

Information for learners

The helpdesk can help you with:

- Help if you can't log in

email or phone your helpdesk if you are stuck

Choosing your site

Once you have logged on you will see the sites you have registered for. Choose one by clicking on the large blue text.

You are logged in as [OLP Us](#)

Edit

Free Software and Online Tools

Using Moodle

Working with Figures

these are the sites registered for this user. Select by clicking

Bookmarking / adding to favourites

Each individual Moodle site has its own web address or URL. You can add these addresses to your bookmarks to save time when you go back to the sites.

<http://www.olponline.co.uk/course/view.php?id=34>

View Favorites Tools Help

Course: Using Moodle

Moodle

page ► Using Moodle

Participants

a guide to using

add this address to your explorer favorites

checklist

Make a note of your Moodle URL, username and password

Remember that usernames and passwords are case sensitive

Contact the OLP helpdesk if you are stuck

Add your Moodle addresses to favorites in Internet Explorer, Bookmarks in Firefox or the equivalent in other browsers

Open Learning Partnership©2009

Contact us for information about training, support, hosting, authoring materials

info@olp.org.uk

www.olp.org.uk